

Laboratory benches

Bench with self-supporting underbench units

Intended use

- Self-supporting underbench unit on plinth with worktop made of various materials as a work surface and storage area for laboratory work
- Supporting construction for analytical equipment and superstructures

Design

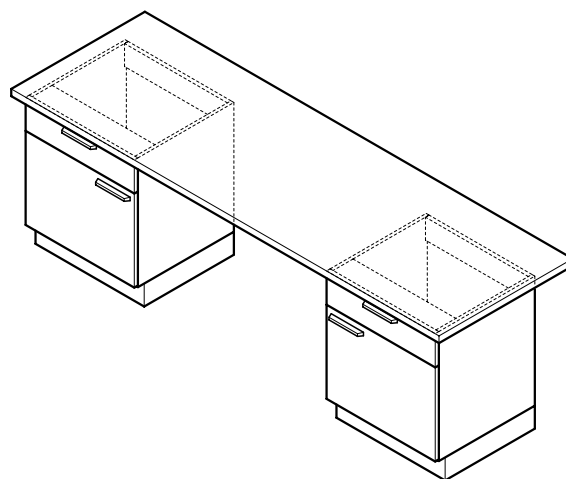

Technical data

Dimensions	
Overall width [mm]	Max. 3000
Width, underbench unit [mm]	450 600 900 1200
Total depth [mm]	750 900
Working height [mm]	750 900

Material	
Worktop	Depending on width and requirement

Load bearing capacity	
Bench with self-supporting underbench unit [kg]	200