

Underbench units

Underbench unit for sinks

Intended use

- As an underbench unit for sinks for storing equipment and chemicals in acc. with EN 14727
- Not suitable for storing flammable liquids, gas cylinders and self-igniting or self-decomposing substances
- Not suitable for storing acids and alkalis

Design

Sink with underbench unit for service spines or wall benches

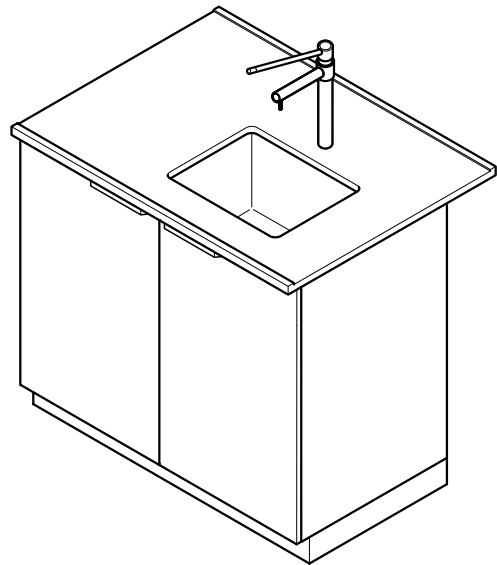

End sink for double benches

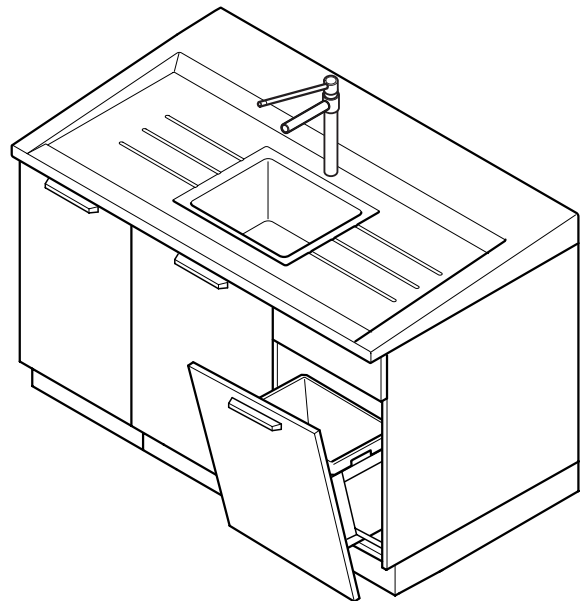

Underbench units

Underbench unit for sinks

Variants

Sink with underbench unit for service spines or wall benches

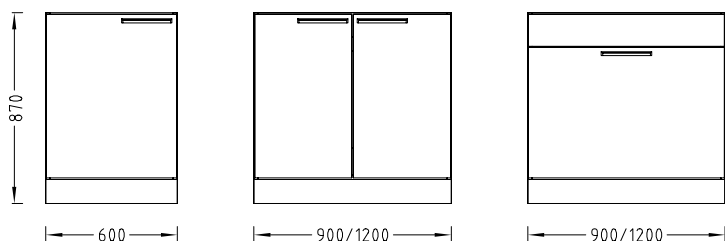

End sink for double benches

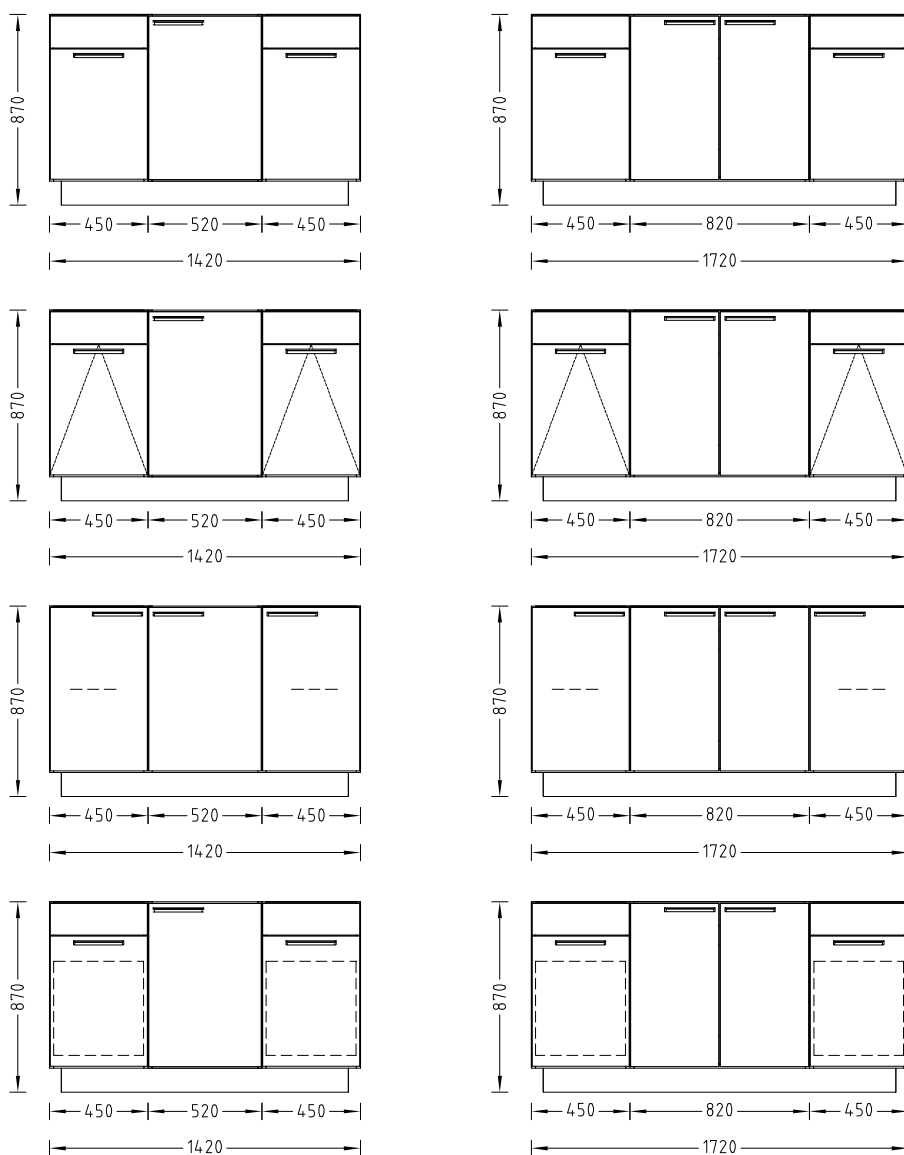

Underbench units

Underbench unit for sinks

Technical data

Dimensions					
Width [mm]	600 ¹⁾	900 ¹⁾	1200 ¹⁾	1420 ²⁾	1720 ²⁾
Depth [mm]	550			700	
Overall height [mm]	870				
Height, plinth [mm]	110				

¹⁾ For sinks on service spines or wall benches

²⁾ For end sinks

Load bearing capacity	
Per shelf/drawer [kg]	30

Design characteristics	
Construction	Hinged doors with 270° hinges 4 height-adjustable feet Inclined swivel door with waste bin 30 l Waste bin 2 x 15 l with full-height drawer Waste bin 2 x 35 l with full-height drawer Hinged door(s), full-height drawer Combination possibilities see variants
Handle	Handle bar SCALA U handle, stainless steel
Closing	Optional